

ASO ONLY (APPLICATION SPECIFIC ORDER)

QTH-XXX-01-X-D-EMX-XX

EDGE MOUNT	"A"	"B"	"C"	BODY	CONTACT
-EM2	.130[3.30]	.0670[1.702]	.058[1.47]	QTH-30-01-D-EM2-XX	T-1S42-01-X
*-EM3	.160[4.06]	.0980[2.489]	.088[2.24]	QTH-30-01-D-EM3-XX	T-1S42-02-X

* = SEE NOTE 12

No OF POSITIONS
-030, -060, -090,
N **120, **150
(PER ROW)
N **SEE NOTE 13

OPTION
-TY: TRAY PACKAGING
EDGE MOUNT THICKNESS
-EM2: .064[1.63] +/- .004 PCB
(USE QTH-30-01-D-EM2-XX &
T-1S42-01-X)
-EM3:
(USE QTH-30-01-D-EM3-XX &
T-1S42-02-X)
SEE NOTE 12

LEAD STYLE
-01: .1680[4.267]

ROW SPECIFICATION
-D: DOUBLE
(USE QTH-30-01-D-EMX-XX)

PLATING SPECIFICATION No OF BANKS
-F: FLASH SELECTIVE GOLD WITH MATTE TIN TAILS
(USE T-1S42-XX-F & T-1G1-01-F) [SEE NOTE 8]
-L: LIGHT SELECTIVE GOLD WITH MATTE TIN TAILS
(USE T-1S42-XX-L & T-1G1-01-L)
-H: HEAVY GOLD
(USE T-1S42-XX-H & T-1G1-01-G)
-C: ELECTRO-POLISHED SELECTIVE
(USE T-1S42-XX-C, T-1G1-01-L)

DO NOT SCALE FROM THIS PRINT

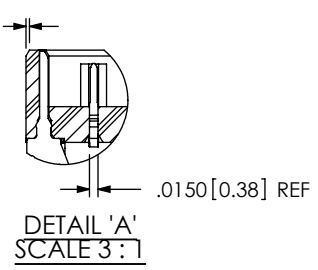
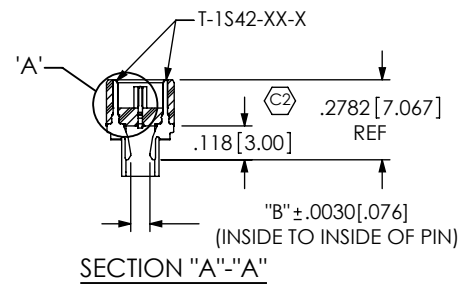
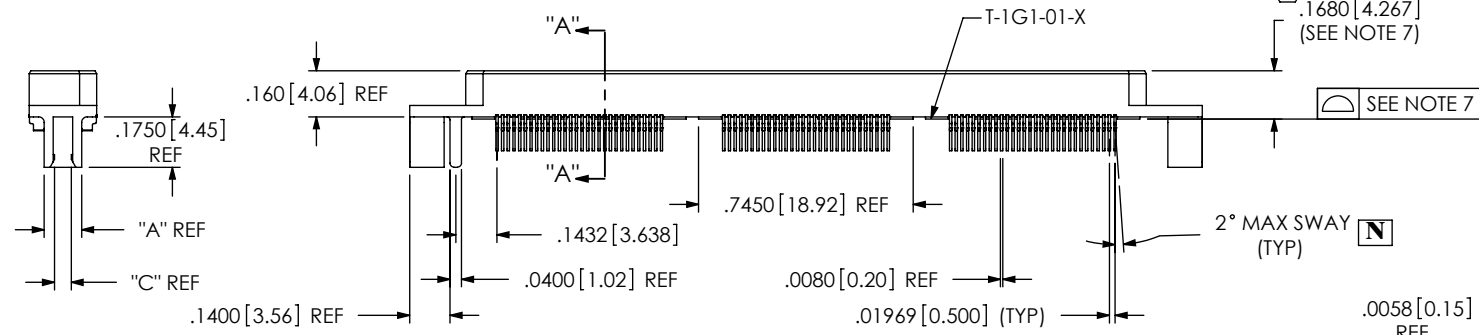
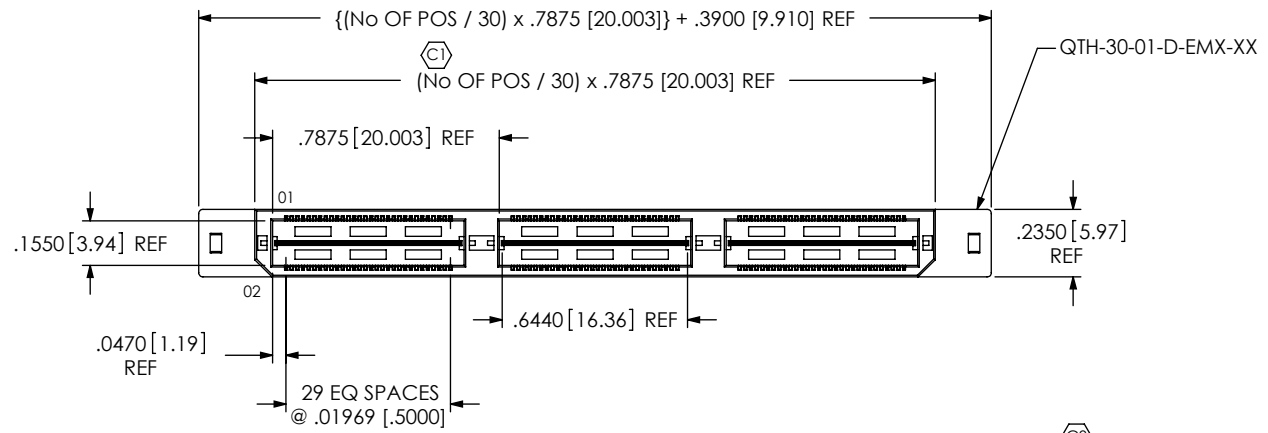

NOTES:

1. C REPRESENTS A CRITICAL DIMENSION.
2. BURR ALLOWANCE: $.0015 [0.38]$ MAX.
3. MINIMUM PUSHOUT FORCE: 5 OZ.
4. MINIMUM GROUND PLANE RETENTION: 1 LB.
5. NOTE DELETED.
6. PARTS TO BE MOLDED TO POSITION.
7. GROUND PLANE TO BE WITHIN $.004 [0.10]$ COPLANARITY & MAX VARIANCE OF $.002$.
8. -L PLATING CAN BE SUBSTITUTED FOR -F PLATING (TERMINAL),
-G PLATING CAN BE SUBSTITUTED FOR -F PLATING (GROUND PLANE).
9. NOTE DELETED.
10. BOARD THICKNESS TO BE MEASURED FROM SOLDER PAD TO SOLDER PAD.
11. SEE www.samtec.com/processing/edgemt_tectalk/index.htm FOR PROCESSING EDGE MOUNT PARTS TO BOARD.
12. -EM3 IS NOT A STANDARD OFFERING; AVAILABLE AS AN ASP ONLY. PLEASE CONTACT SAMTEC INTERCONNECT PROCESSING GROUP WITH ORDER INQUIRIES
13. FOR NEW APPLICATIONS REQUIRING THESE POSITIONS, PLEASE CONTACT SAMTEC INTERCONNECT PROCESSING GROUP.



No OF POSITIONS	MAX BOW
-030, -060, -090	$.004 [0.10]$
-120, -150	$.006 [0.15]$

UNLESS OTHERWISE SPECIFIED, DIMENSIONS ARE IN INCHES.
TOLERANCES ARE:
DECIMALS ANGLES
.XX: ± $0.1 [3]$
.XXX: ± $0.05 [13]$
.XXXX: ± $0.020 [0.51]$

PROPRIETARY NOTE
THIS DOCUMENT CONTAINS INFORMATION CONFIDENTIAL AND PROPRIETARY TO SAMTEC, INC. AND SHALL NOT BE REPRODUCED OR TRANSFERRED TO OTHER DOCUMENTS OR DISCLOSED TO OTHERS OR USED FOR ANY PURPOSE OTHER THAN THAT WHICH IT WAS OBTAINED WITHOUT THE EXPRESSED WRITTEN CONSENT OF SAMTEC, INC.



MATERIAL: DO NOT SCALE DRAWING SHEET SCALE: 1.5:1
INSULATOR: LCP, COLOR: BLACK
TERMINAL & GROUND PLANE: PHOS BRONZE

DESCRIPTION:
.5mm HS EDGE MOUNT TERMINAL ASSEMBLY

DWG. NO.
QTH-XXX-01-X-D-EMX-XX

BY: DEAN P 4/20/2000 SHEET 1 OF 1